

CH4204 Chassis Monitor 1920x1080

- Built-in fans to improve system cooling allows up to 24-hours a day usage
- Optional built-in touch screen for interactive applications
- Optional auto-brightness sensor offers application by day and night
- Optional with different frames (Open Frame, Panel Mount, Rack Mount etc)



Specifications

| | | | |
|-----------------------------|--|--|--|
| Panel: | Cell Type / Glass Surface | TFT LCD / Black Anti-Glare, low reflection coating | |
| | Aspect Ratio / Size | Wide / 42" viewable diagonal area | |
| | Active Area / Pixel Pitch | 930.24(H) x 523.26(V) / 0.4845(H) x 0.4845(V) mm | |
| | Native Res. / Colors | 1920(H) x 1080 (V) / 16.7 Million | |
| | Brightness / Contrast | 350 cd/m2 (typ) / 1500:1 | |
| | Response Time | <8ms | |
| | Viewing Angle | H. 178° (-89° ~ + 89°), V. 178° (-89° ~+ 89°) | |
| | Light Source | LED, Long Life 35.000 hrs (typ) | |
| Input Sources: | Audio System | 2W Speaker x 2 | |
| Input Terminals: | 1 x VGA (15 Pin Female D-SUB) 1x PC Audio (Stereo headphone Jack) 1 x DC Power Plug | | |
| Convenient Features: | Auto Calibration, Back Light Adjustment, Plug & Play (VESA DDC/CI, DDC 2B) OSD Multi Languages, Wall Mount Ready (VESA 600 x 200 mm) | | |
| Power: | Internal power supply with universal / Auto-Sensing, AC 90 to260 V, 50 / 60 Hz | | |
| Power cons. | Operation / Power saving | 142 watt, <1 watt (Support DPMS) | |
| Op. Condition | Temperature / Humidity | 0°C ~ 50°C, 10% ~ 90% (no condensation) | |
| | Temperature / Humidity | -20°C ~ 60°C, 10% ~ 90% (no condensation) | |
| Dimensions: | Physical | WxHxD = please see drawing | |
| Weight: | N.W. / G.W | 30.5 kg / 32.5 kg | |
| Options: | Touch | Enhanced Panel | Others |
| | SAW Touch Infrared Touch | Protection Glass High Brightness Wide Temperature Sunlight Readable | Digital Signage Motion Sensor Light Sensor Auto-Dimming SV+AV, DVI, HDMI etc |

Errors and omissions excepted !

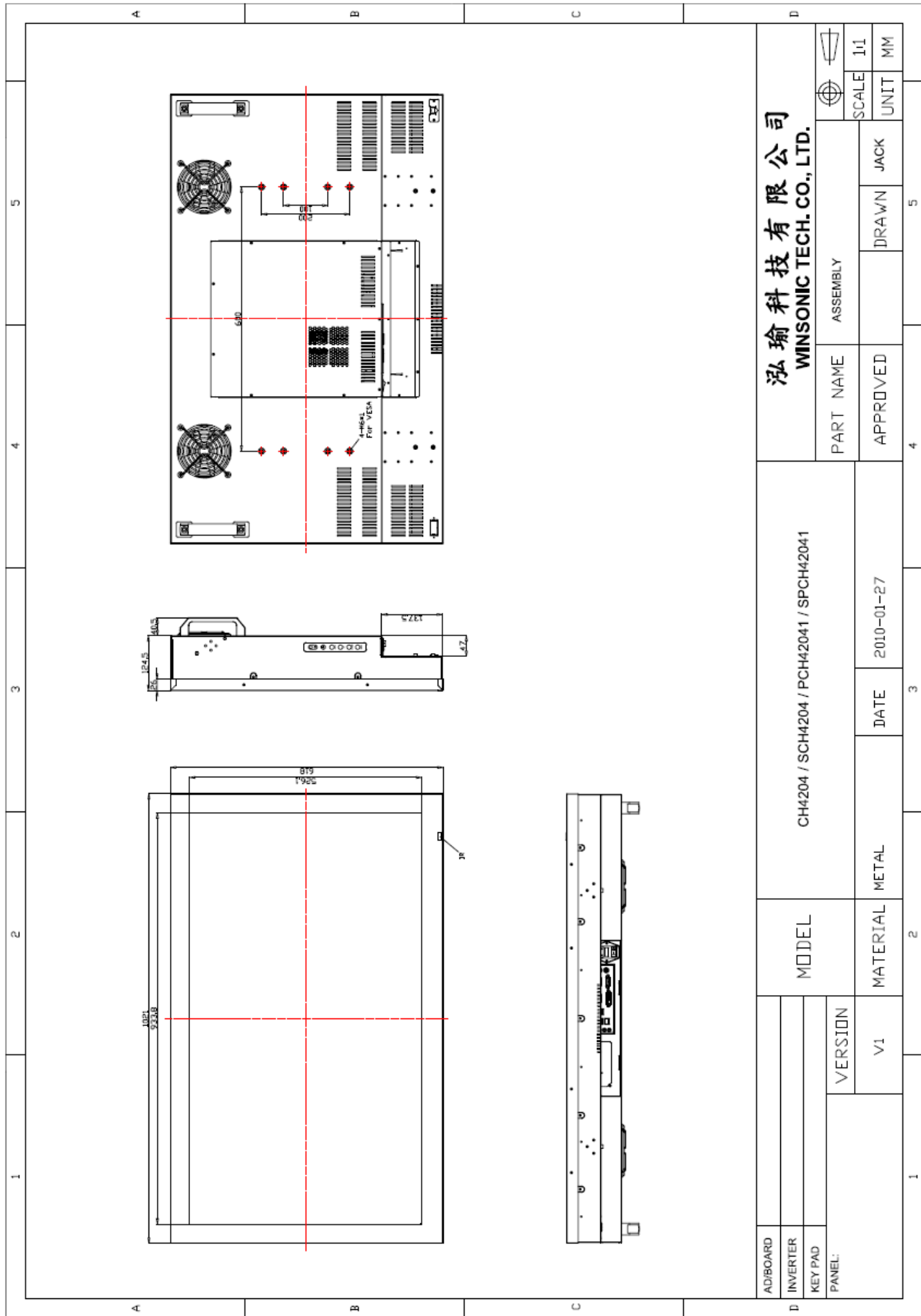

Full-size drawing available on request !